

This survey was prepared at the request of Logan Hoyt, Cuming County, Nebraska.

LEGAL DESCRIPTIONS

TRACT I
 A tract of land located in the North 1/2 of the Southeast 1/4 of Section 15, T22N, R4E of the 6th P.M., Cuming County, Nebraska, more particularly described as follows:

Beginning at the East 1/4 Corner of Section 15, T22N, R4E of the 6th P.M., Cuming County, Nebraska; thence S 02°00'16" E on an assumed bearing on the East line of the Southeast 1/4, 650.00 feet; thence S 88°19'00" W, 740.00 feet; thence S 89°04'00" W, 520.00 feet; thence S 89°49'00" W, 305.00 feet; thence N 87°42'00" W, 625.00 feet; thence N 07°24'00" E, 150.00 feet; thence S 89°23'10" W, 480.51 feet to a point on the West line of said Southeast 1/4; thence N 01°41'08" W on said West line, 420.00 feet to the Center of said Section 15; thence N 87°59'53" E on the North line of said Southeast 1/4, 2641.51 feet to the Point of Beginning, containing 36.11 acres, more or less.

TRACT II
 A tract of land located in the North 1/2 of the Southeast 1/4 of Section 15, T22N, R4E of the 6th P.M., Cuming County, Nebraska, more particularly described as follows:

Commencing at the East 1/4 Corner of Section 15, T22N, R4E of the 6th P.M., Cuming County, Nebraska; thence S 02°00'16" E on an assumed bearing on the East line of the Southeast 1/4, 650.00 feet to the Point of Beginning; thence S 88°19'00" W, 740.00 feet; thence S 89°04'00" W, 520.00 feet; thence S 89°49'00" W, 305.00 feet; thence N 87°42'00" W, 625.00 feet; thence N 07°24'00" E, 150.00 feet; thence S 89°23'10" W, 480.51 feet to a point on the West line of said Southeast 1/4; thence S 01°41'08" E on said West line, 640.00 feet; thence N 88°26'03" E, 640.69 feet; thence N 01°41'08" W and parallel to said West line, 430.00 feet; thence S 89°14'00" E, 440.00 feet; thence N 89°49'00" E, 305.00 feet; thence N 89°04'00" E, 520.00 feet; thence N 88°19'00" E, 740.00 feet to a point on said East line; thence N 02°00'16" W on said East line, 25.00 feet to the Point of Beginning, containing 10.02 acres, more or less.

TRACT III
 A tract of land located in the Southeast 1/4 of Section 15, T22N, R4E of the 6th P.M., Cuming County, Nebraska, more particularly described as follows:

Commencing at the East 1/4 Corner of Section 15, T22N, R4E of the 6th P.M., Cuming County, Nebraska; thence S 02°00'16" E on an assumed bearing on the East line of the Southeast 1/4, 675.00 feet to the Point of Beginning; thence S 02°00'16" E on said East line, 1968.86 feet to the Southeast Corner of said Section 15; thence S 88°03'52" W on the South line of said Southeast 1/4, 2656.20 feet to the South 1/4 Corner of said Section 15; thence N 01°41'08" W on the West line of said Southeast 1/4, 1580.82 feet; thence N 88°26'03" E, 640.69 feet; thence N 01°41'08" W and parallel to said West line, 430.00 feet; thence S 89°14'00" E, 440.00 feet; thence N 89°49'00" E, 305.00 feet; thence N 89°04'00" E, 520.00 feet; thence N 88°19'00" E to a point on said East line, 740.00 feet to the Point of Beginning, containing 114.56 acres, more or less.

SURVEYOR'S CERTIFICATE

I, Terry L. Schulz, a Registered Land Surveyor of the State of Nebraska, do hereby certify that the survey described above was made by me or under my direct supervision on September 2, 2021; also that all dimensions are in feet and are correct to the best of my knowledge and belief.

Terry L. Schulz, State of Nebraska, R.L.S. #550 Date 9-10-2021

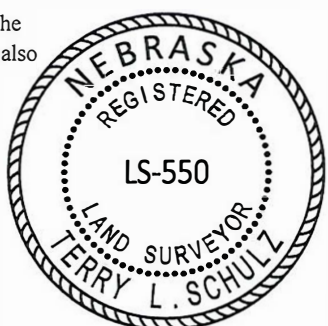

Drawn By: HJM
 Date: September 2, 2021
 Project Number: S-020-418
 Scale: 1" = 400'

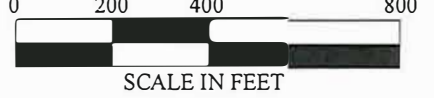

- LEGEND**
- Section Corner Found
 - Property Corner Set (5/8" x 24" I.B. w/Cap)
 - Calculated Point
 - M Measured Distance
 - R Recorded Distance (RWB) Raymond W. Bailey, RLS #84, Dated May 27, 1982 Book #4, Page 261, Dated December 23, 1951 (GAH) G. A. Heller, Book #2, Page 209 (NS) Nick Seery, RLS #689, Dated August, 2021
 - C Calculated Distance

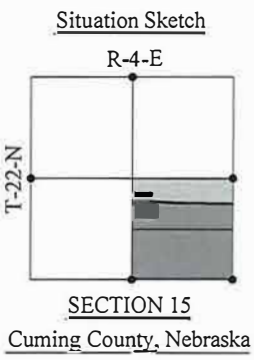

ADVANCED CONSULTING ENGINEERING SERVICES
 133 W. Washington St. • P.O. Box 218
 West Point, NE 68788
 Phone: (402) 372-1923